

SERIES 339

DIGITAL JAW TYPE MICROMETER



- ◆ Resolution: 0.001mm/0.00005"
- ◆ Buttons: on/off, set, mm/inch, ABS/INC data output
- ◆ Automatic power off
- ◆ Data output
- ◆ Non-rotating spindle
- ◆ Supplied with setting standards (except 339-001-01)



339-001-01

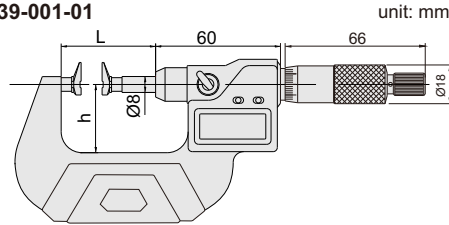

Setting standards(included)

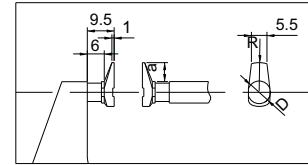

Application

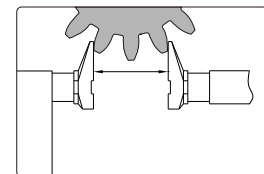
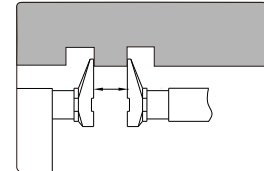

Code	Range	Accuracy	L	a	h	R	D	Setting standards(included)
339-001-01	0-25mm/0-1"	4μm	43	6.5	32	10	8	-
339-002-01	25-50mm/1-2"	4μm	85	6.5	44.5	10	8	25mm
339-003-01	50-75mm/2-3"	5μm	110	6.5	57	10	8	50mm
339-004-01	75-100mm/3-4"	5μm	135	6.5	70	10	8	75mm
339-005-01	100-125mm/4-5"	6μm	160	11.5	86	15	12	100mm
339-006-01	125-150mm/5-6"	6μm	186	11.5	94.5	15	12	125mm
339-007-01	150-175mm/6-7"	7μm	211	11.5	107	15	12	150mm
339-008-01	175-200mm/7-8"	7μm	236	11.5	120	15	12	175mm

