



- ◆ Made of alloy steel
- ◆ Meet ASME B89.1.9
- ◆ With manufacturer inspection certificate
- ◆ Code explanation

514-□□□-□XI

- 0: grade0
- 1: grade1
- 2: grade2



514-000-4XI

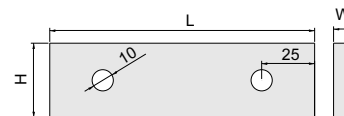

With hole (size $\nabla 5^\circ$)

Size:

Size (L)	W	H
.02" \leq L \leq .394"	.354"	1.181"
L > .394"	.354"	1.378"

Example:

Code	Grade	Size (L)
514-000-10I	0	1"
514-000-11I	1	1"
514-000-12I	2	1"

Code	Size(L)
514-000-1XI	1"
514-000-2XI	2"
514-000-3XI	3"
514-000-4XI	4"
514-000-5XI	5"
514-000-6XI	6"

Code	Size(L)
514-000-7XI	7"
514-000-8XI	8"
514-010-0XI	10"
514-012-0XI	12"
514-016-0XI	16"
514-020-0XI	20"

